

## UB 18DG

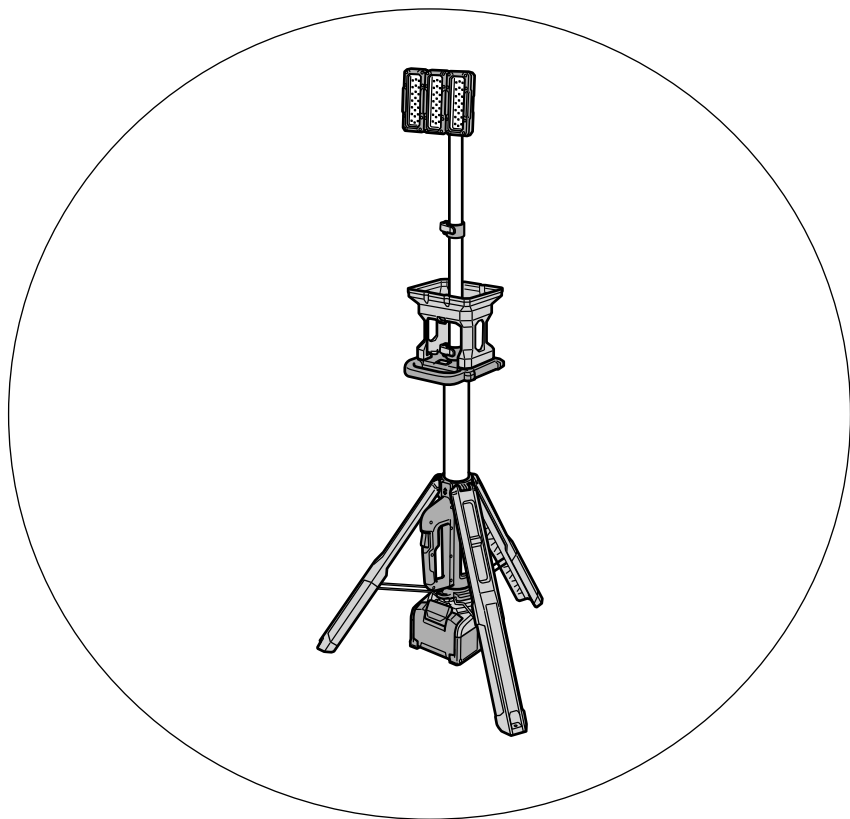

简体中文 使用说明书

English Handling instructions

1

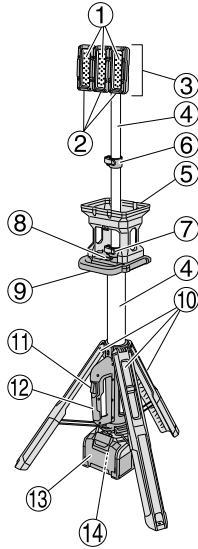

2

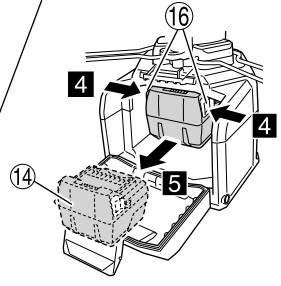
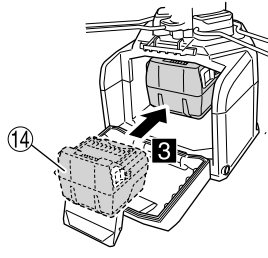
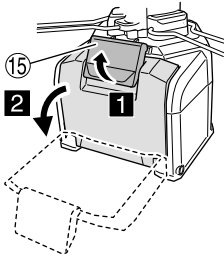

3

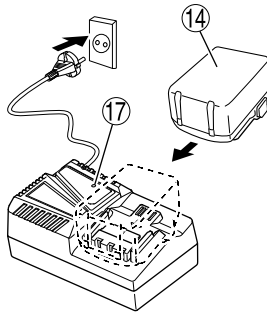

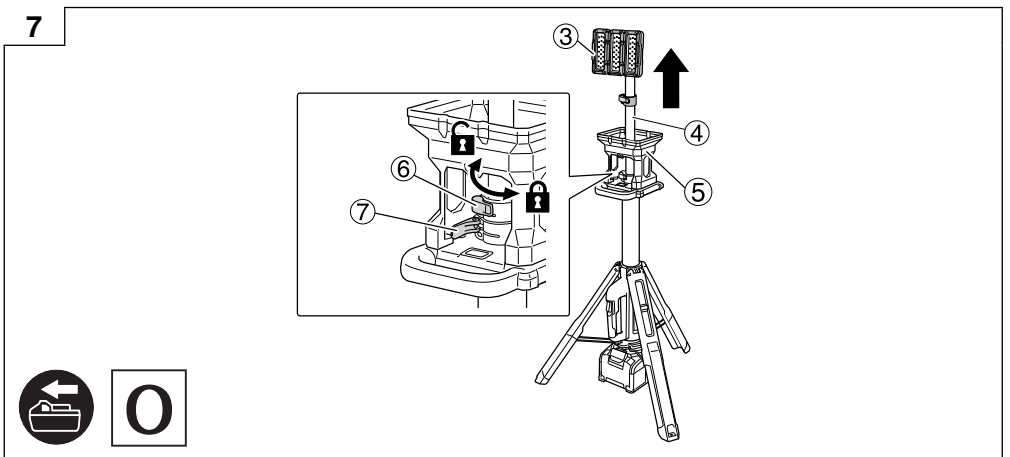
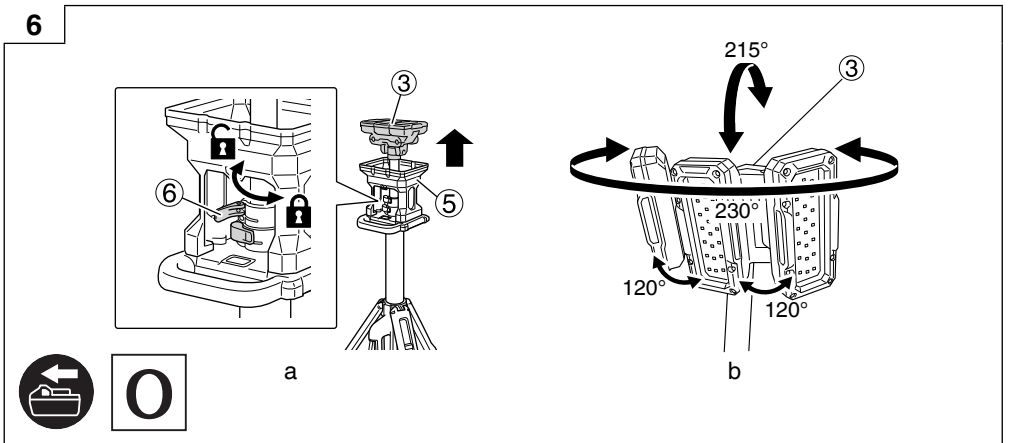
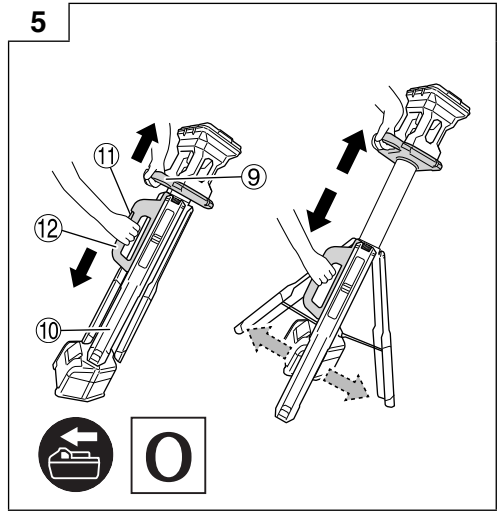
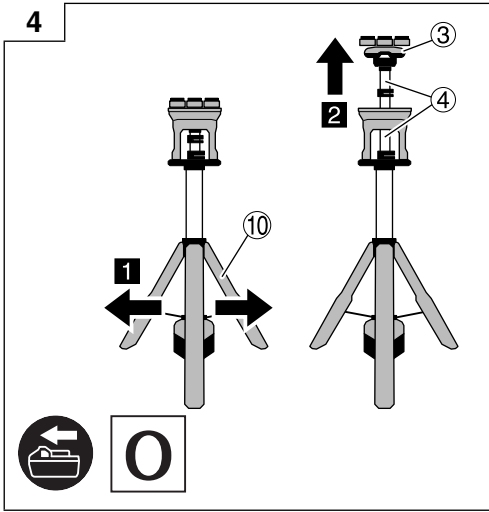

8

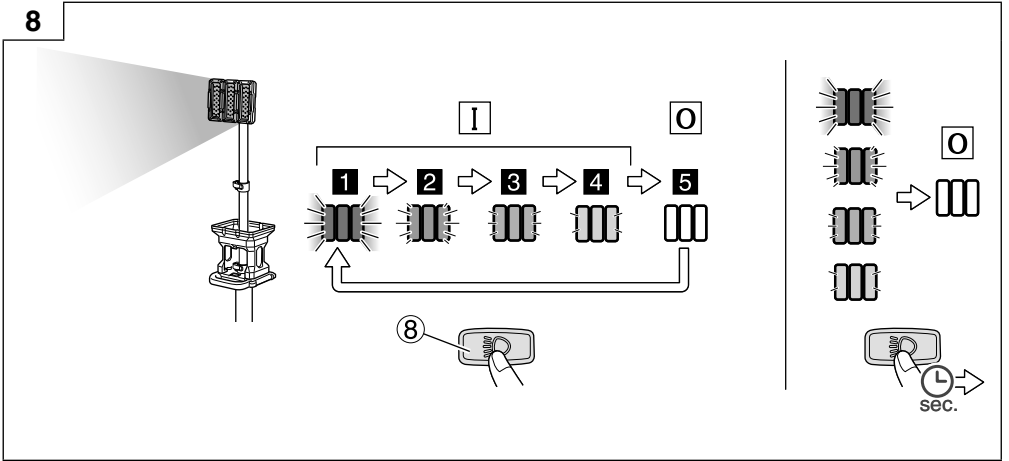

9

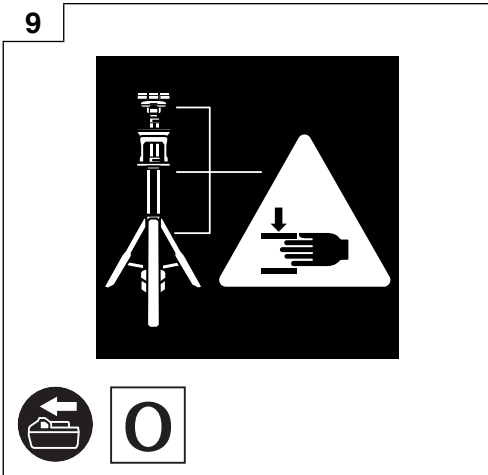

10

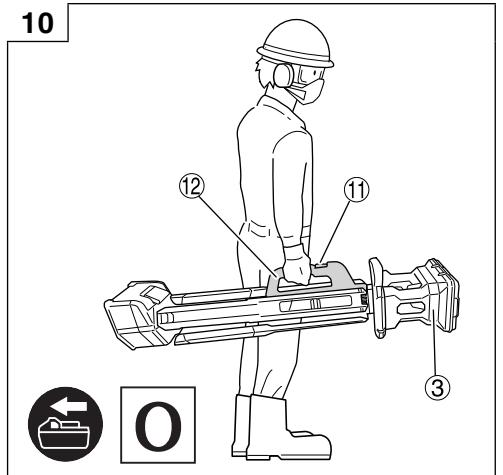

11

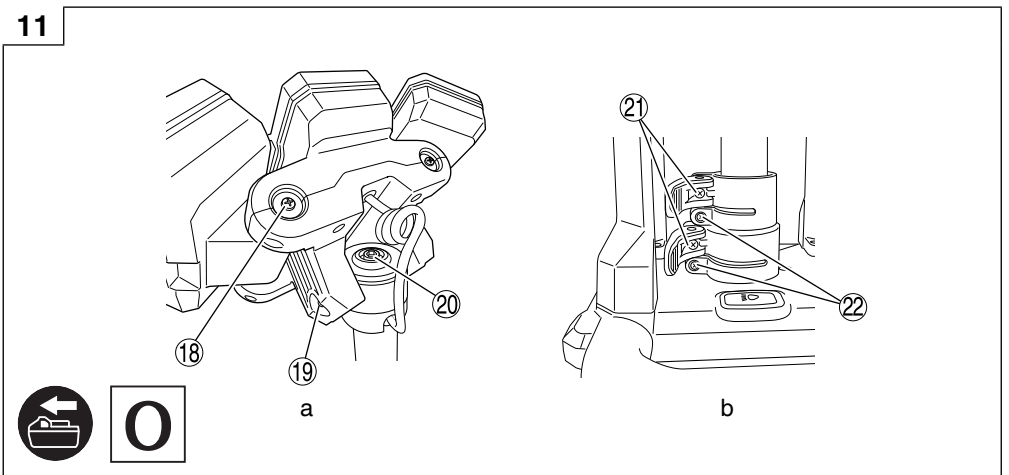

## 充电式灯塔安全警告

### ⚠ 警告

阅读所有安全警告和所有说明。

不遵照以下警告和说明会导致电击、着火和/或严重伤害。

保存所有警告和说明书以备查阅。

1. 仅遵照本说明书所述进行使用。仅使用制造商推荐的附件。
2. 请勿在有可燃液体、气体或灰尘等物的易爆环境中使用灯塔。
3. 请勿在潮湿地点或雨中使用灯塔。
  - 否则可能会导致电击、冒烟或故障。
4. 请勿拆卸或改装灯塔
  - 否则可能会导致电击或火灾。检查和维修应由购买商店或由HiKOKI电动工具服务中心进行。
5. 请勿使任何未知物体或水分进入灯塔机身内部。
  - 如果任何金属或易燃物或水进入电池盖和USB端口橡胶盖，可能导致触电或火灾。
6. 小心电击。
7. 在不使用三脚架灯时，或者在准备、储存或运输时，务必关闭机器上的开关并卸下电池。
8. 请勿在灯亮起期间，使用布、纸板或其他材料将灯塔覆盖。
9. 灯打开时，请勿直视、将其对准人或动物，或瞄准眼睛。
10. 在点亮及刚使用之后，镜头会保持高温，因此请勿触摸。
11. 请勿在雨中或潮湿地点使用、放置或储存灯塔。
12. 请勿将灯塔放置在车中或会暴露于日光热源下的地点（超过50°C）。否则会导致故障。
13. 请勿在灯塔开启期间将其放置而无人看管。
14. 请勿在强风中使用三脚架。
15. 在高空作业时，确保下方无人，根据使用环境采取必要的预防措施，以防三脚架翻倒或掉落。
16. 如镜头损坏或未安装，则请勿使用三脚架灯。
17. 让有资质的维修人员维修灯塔，并仅使用完全一致的更换部件。
  - 这将保证灯塔的安全性得以维持。
18. 灯塔仅可使用特别指定的可充电电池。
  - 如使用其它任何充电式电池，将有导致人员受伤及起火的危险。
19. 需再充电时，仅能使用制造商指定的充电器。
  - 因充电器仅适合同一型号的充电式电池，如使用任何其它电池，将有导致起火的危险。

20. 当充电式电池不使用时，请将其远离如回形针、钱币、钥匙、图钉、螺钉或其他会在电池两极间形成链接的小型金属物件。
  - 电池两极间短路会造成灼伤或引起火灾。
21. 若使用不当，可能会有液体从电池渗出；请避免接触该液体。若不慎接触，请以清水冲洗。如果不小心让液体接触到眼睛，请立即就医。
  - 电池渗出的液体可能会导致刺激或灼伤。
22. 不应将电池暴露在阳光、火等过热环境中。

## 其他安全警告

1. 始终在0°C - 40°C的温度下对电池进行充电。温度低于0°C将导致危险的过充电。不得在高于40°C的温度下对电池进行充电。最适于充电的温度是20°C - 25°C。
2. 请勿连续使用充电器。
  - 充电结束后，在下次充电之前请将充电器放置约15分钟。
3. 勿让异物进入连接充电式电池的孔中。
4. 切勿拆卸充电式电池与充电器。
5. 切勿使充电式电池短路。电池短路会引起强电流和过热。从而烧坏电池。
6. 请勿将电池丢入火中。电池受热将会爆炸。
7. 充电后电池寿命太短不够使用时，请尽快将电池送往经销店。请勿将用过的电池乱丢。
8. 请勿将异物插入充电器的通风口。将金属物体或易燃物插入充电器的通风口会导致触电事故或损坏充电器。
9. 请确保蓄电池安装牢固。电池松动后，可能脱落并引起事故。
10. 请勿使用工具或电池端子（电池安装部位）明显变形的产品。
  - 否则，安装电池后可能会短路，造成冒烟或起火。
11. 使工具端子（电池安装）保持无尘。
  - 使用前，务必使端子区域无灰尘积累。
  - 使用期间，尝试避免使工具上的灰尘掉落在电池上。
  - 在停止操作时或使用后，请勿将工具留在可能会暴露于掉落灰尘的区域中。
12. 请在-5 - 40°C环境下使用本工具及电池。

## 锂离子电池使用注意事项

为延长使用期限，锂离子电池配备停止输出的保护功能。

在下方1-3所述的情况下使用本产品时，即使开关打开，工作灯也可能无法开启。这并非故障问题，而是保护功能作用的结果。

1. 当剩余电池电量耗尽时，工作灯关闭。  
在这种情况下，请立即充电。
2. 如工具过载，工作灯可能会关闭。在这种情况下，请松开工具的开关并消除过载的原因。然后再重新使用。
3. 如在工作过载时电池过热，电池可能会停止输出电量。  
在这种情况下，请停止使用电池并让电池冷却。然后再重新使用。

此外，请留心下列的警告及注意事项。

### 警告

为防止发生电池漏液、发热、冒烟、爆炸及起火等事故，请务必注意以下事项。

1. 确保电池上没有堆积削屑和灰尘。
  - 在工作时确保削屑和灰尘没有掉落在电池上。
  - 确保工作期间落在工具上的任何削屑和灰尘都不会堆积在电池上。
  - 请勿将未使用的电池存放在暴露于削屑和灰尘的位置。
  - 在存放电池之前，请清除任何可能附着在上面的削屑和灰尘，并不要将电池与金属零件（螺丝、钉子等）存放在一起。
2. 请勿以钉子等利器刺穿电池、以铁锤敲打、踩踏、丢掷电池，或将其剧烈撞击。
3. 请勿使用明显损坏或变形的电池。
4. 请按规定方式使用电池，切勿移作他用。
5. 如果已过了再充电时间，电池仍无法完成充电，请立即停止继续充电。
6. 请勿将电池放置于高温或高压处，例如微波炉、烘干机或高压容器内。
7. 发现有渗漏或异味时，请立即将电池远离火源处。
8. 请勿在会产生强烈静电的地方使用。
9. 如电池出现渗漏、异味、发热、褪色或变形，或在使用、充电或存放时出现任何异常，请立即将电池从装备或电池充电器中取出，并停止使用。
10. 请勿浸泡电池或让任何液体流入电池内部。导电液体进入（如水），可能造成电池损坏，甚至可导致火灾或爆炸。将电池存放在阴凉、干燥的地方，远离易燃物品。必须避免将电池置于腐蚀性气体环境中。

### 注意

1. 如电池渗漏出的液体进入您的眼睛，请勿搓揉眼睛，并以自来水等干净清水充分冲洗，立刻送医。  
如不立即处理，液体可能会导致眼睛不适。
2. 如液体渗漏至您的皮肤或衣物，请立即以自来水等清水冲洗。  
上述情况可能会导致皮肤过敏。
3. 如初次使用电池时发现生锈、异味、过热、褪色、变形和/或其他异常情况时，请勿使用并将该电池退还给供货商或厂商。

### 警告

若具有导电性的异物进入锂离子电池的端子，可能会造成短路，进而引发火灾。请在存放电池时遵循以下事项。

- 请勿在电池盒内放置导电物体，如钉子和铁丝、铜丝等电线放置在中。
- 为防止发生短路，请将蓄电池装入工具中，或将蓄电池盖牢固插入以进行存储，直到看不到通风机为止。

## 关于锂离子电池的运输

运输锂离子电池时，请遵守以下注意事项。

### 警告

安排运输时，请通知运输公司包裹中含有锂离子电池，告知该电池的输出功率，并遵照运输公司的指示。

- 超过100Wh输出功率的锂离子电池被归类为危险物品，将需要特殊的申请程序。
- 对于在国外运输，必须遵守国际法规和目的国法规。

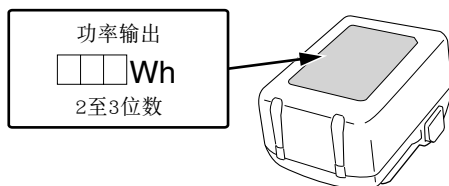

## 防尘和防水功能注意事项

本产品符合国际IEC标准中规定的电气设备IP55防护等级（防尘和防水）。（在电池盖关闭时，工具机本身本身可达到相当于IP55防护标准的水平。）

### [IP代码描述]

#### IP55

防水等级

从任何方向喷溅的水不会产生有害影响（防喷水）

固体异物侵入防护等级

少量灰尘的出现不会影响正常操作（防尘）。

虽然设备已配备了防尘、防水设计，但并不能排除发生故障的可能性。请勿将设备放置在可能会存在大量灰尘、溅到大量水或雨水的环境中。

## 部件名称（图1—图11）

①	镜头	⑫	握把
②	侧盖	⑬	电池盖
③	LED单元	⑭	电池（另售）
④	延长杆	⑮	夹紧杆
⑤	储存盖	⑯	卡扣
⑥	锁定杆 (A)	⑰	指示灯
⑦	锁定杆 (B)	⑱	个螺钉（×2 各顶部和底部）（单个灯角度调整）
⑧	开关	⑲	个螺钉（×2）（垂直角度调整）
⑨	上把手	⑳	个内六角头螺钉（水平角度调整）
⑩	腿	㉑	个锁定杆上部螺钉
⑪	腿开启杆	㉒	个锁定杆下部螺钉（在未能足够拧紧上部螺钉时进行调整）



	为降低伤害风险，用户必须阅读使用说明书。
	直流电流
	交流电流
	请勿在LED灯亮起时对其直视。
	断开连接电池
	打开
	关闭
	锁定
	解锁
	警告
V	伏特
A	安培
W	瓦特
IPXX	IP符号

## 符号

### 警告

如下所示的符号用于本机。使用前请务必理解其含意。

	UB18DG：充电式灯塔
--	--------------

	务必在延长杆前打开腿。
	请小心在操作期间不要在滑动部件中夹住手或手指。

## 应用

工作场所照明

## 规格

型号	UB18DG		
电压	18 V		
LED (白色)	×66		
亮度调节范围	1000 lm, 2000 lm, 3000 lm, 4000 lm		
运行时间, 约 (使用充满电的电池)*	最大 (4000lm)	3.0Ah:	1.5小时
		5.0Ah:	2.5小时
		8.0Ah:	4.0小时
	高 (3000lm)	3.0Ah:	2.1小时
	5.0Ah:	3.5小时	
	8.0Ah:	5.6小时	
	中 (2000lm)	3.0Ah:	3.3小时
	5.0Ah:	5.5小时	
	8.0Ah:	8.8小时	
	低 (1000lm)	3.0Ah:	6.3小时
	5.0Ah:	10.5小时	
	8.0Ah:	16.8小时	
外部尺寸	延长	H 2150 mm × L 630 mm × W 720 mm	
	缩回	H 1035 mm × L 222 mm × W 210 mm	
重量	8.1 kg (不包含电池)		

\* 显示的运行时间仅为参考值。  
实际时间根据电池的充电状态、使用情况等而异。对于BSL36A18, 请参考5.0 Ah数值; 对于BSL36B18, 请参考8.0 Ah数值。

## 注





由于HiKOKI的持续研究和开发计划, 此处的规格如有更改, 恕不另行通知。

## 充电

使用本工具前, 请按如下方式为电池充电。

1. 将充电器的电源线连接到插座。  
当充电器的插头连接到插座时, 指示灯将呈红色闪烁 (间隔1秒)。
  2. 将电池插入充电器。  
如图3所示, 将电池牢牢地插入充电器。
  3. 充电  
将电池插入充电器时, 将开始充电, 指示灯将持续呈红色点亮。  
当电池充满电时, 指示灯将闪烁红色。(间隔1秒) (参见表1)
- 指示灯指示  
根据充电器或充电式电池的情况, 指示灯的指示如表1所示。

表1

指示灯 (红色) 的指示		
充电前	点亮0.5秒并熄灭 0.5秒 (闪烁) 	插入电源
充电时	连续点亮 (点亮) 	—
充电完成	点亮0.5秒并熄灭 0.5秒 (闪烁) 	—
过热而等待	点亮1秒并熄灭 0.5秒 (闪烁) 	电池过热。无法充电。(电池冷却后开始进行充电)
无法充电	点亮0.1秒并熄灭 0.1秒 (闪动) 	电池或充电器故障



- 关于电池的温度和充电时间。  
温度和充电时间如表2所示。

表2

电池		充电器	UC18YFSL
充电电压	V		14.4-18
重量	kg		0.5
电池可充电的温度			0°C-50°C
电池电容的充电时间约为 (20°C时)			
1.5Ah	分钟		22
2.0Ah	分钟		30
2.5Ah	分钟		35
3.0Ah	分钟		45
4.0Ah	分钟		60
5.0Ah	分钟		75
6.0Ah	分钟		90
8.0Ah	分钟		120
电池芯数			4-10

**注** 充电时间可能因温度和电源电压而异。

**注意** 连续使用充电器会导致发热，从而引发故障。充电完成后，休息15分钟后再进行下一次充电。

4. 将充电器的电源线从插座上拔下。

5. 拿住充电器，并取出电池。

**注** 使用后请务必从充电器取出电池，然后妥善收藏。

#### 关于新电池的放电。

新电池内部的化学物质未被激活或电池长时间不使用时，初次或第二次使用时需要将其放电至较低电量。这是暂时现象，充电2-3次即可恢复正常充电时间。

#### 较长时间保持电池性能的方法

- (1) 在电池电力完全耗尽之前进行充电。  
感到电动工具的能力变弱时，请停止使用并给电池充电。若您继续使用电动工具并耗尽电力，电池可能会损坏或其使用寿命缩短。
- (2) 避免在高温环境中充电。  
使用后充电站式电池的温度将迅速升高。若使用后立即对这种电池进行充电，其内部化学物质会劣化，电池使用寿命将缩短。请稍等片刻，待电池冷却后再进行充电。

#### 注意

- 如果电池长时间放置在阳光直接照射的地方或者刚刚使用完毕时，电池会变热。如果此时对电池充电，充电器的指示灯会点亮1秒钟，然后熄灭0.5秒钟（熄灭0.5秒钟）。此时请待电池冷却后再开始充电。
- 指示灯闪烁（闪烁间隔为0.2秒钟）时，请检查充电器的电池连接器内是否有异物并加以清除。如没有异物，则可能是电池或充电器发生了故障。请将其送往当地授权服务中心。

## 安装和操作

动作	图表	页码
取出及插入电池	2	2
充电	3	2
安装灯塔*1	4	3
打开及关闭腿*2	5	3
调整LED单元的角度*3	6	3
调整LED单元的高度*4	7	3
开启灯*5	8	4
在缩回三脚架时的注意事项*6	9	4
运输三脚架*7	10	4
调整三脚架*8	11	4
选择附件	-	17

\*1 安装灯塔

#### 警告

- 请勿在三脚架会倾倒的地方使用。
- 务必在延长杆前打开腿。

\*2 打开及关闭腿

#### 警告

- 在腿完全分开且锁定到位的情况下使用本产品。
- 请小心在操作期间不要在滑动部件中夹住手或手指。

\*3 调整LED单元的角度

- (1) 松开锁定杆 (A)，升起LED单元约 30 cm，然后再将锁定杆 (A) 锁定到位。（图 6-a）现在调整镜头角度。（图 6-b）
- (2) 调整角度后，释放锁定杆 (A)，并将LED单元升起至所需高度。一旦到达所需位置，则再次将锁定杆 (A) 锁定到位。如单元过低，则释放锁定杆 (B)，并按需延长。

## 简体中文

\*4 调整LED单元的高度

### 警告

- 请小心在操作期间不要在滑动部件中夹住手或手指。
- 除调整高度外，其他时候务必使锁定杆保持锁定。
- 要防止人身伤害，请在不使用时缩回杆。

### 注

在调整LED单元的角度前关闭灯。

\*5 开启灯

在电池电量降至5%或以下时，灯将每三分钟短暂闪烁以警示用户。如此情况发生，则更换电池。

\*6 在缩回三脚架时的注意事项

### 警告

请小心在操作期间不要在滑动部件中夹住手或手指。

\*7 运输三脚架

### 警告

在移动或运输三脚架灯时：

- 关闭开关，并从三脚架灯上卸下可充电电池。
- 将LED单元的背面放入其储存盖。
- 固定锁定杆 (A) 和 (B)。
- 折叠三脚架。
- 关闭电池盖。

### 注

- 握住三脚架使LED单元朝向前方。
- 握住三脚架握把后端，小心勿按压腿打开杆。  
注意，如锁释放且三脚架可移动，则可能会发生事故。
- \*8 如滑动部件由于使用变松动，则通过重新拧紧螺钉进行调整。  
如仅调整上部螺钉无法重新拧紧，则调整下部螺钉。（图 11-b）

## 维护和检查

### 警告

在长时间不使用三脚架灯时，或在为其进行维护、检查或储存时，务必关闭开关并卸下电池。

#### 1. 检查安装的螺丝

定期检查所有安装的螺丝，确保螺丝已完全拧紧。如果螺丝松动，请立即重新拧紧。否则可能导致严重的危险。

#### 2. 检查端子（工具和电池）

确保端子上没有堆积削屑和灰尘。

在操作前、操作时和操作后需要时常检查。

### 注意

请清除端子上的削屑或灰尘。

否则可能导致故障。

#### 3. 清洁外部

在充电式灯塔脏污时，请用干软布或沾有肥皂水的布擦拭。

请勿使用会溶化塑料的含氯溶剂、汽油或油漆稀释剂。

#### 4. 存放

将充电式灯塔及电池存放在温度低于40°C、且儿童无法触及的位置。

### 注

存放锂离子电池

存放锂离子电池前，确保其已充满电。

电池在低电力的状态下长期存放（3个月以上），可能会导致性能劣化，电池的使用时间显著降低或无法再进行充电。

然而，反复将电池充电和暂停充电二至五次，可能会改善电池使用时间的显著降低情况。

反复充电后，若电池的使用时间仍呈现极短现象，表示电池寿命已尽，请购买新的电池。

### HiKOKI 充电工具电池的重要注意事项

请务必使用本公司所指定的原厂电池。如未使用本公司指定的电池，或使用经拆解及改装的电池（例如，拆解后更换电池芯或其他内部零件），则本公司无法保证充电式工具的性能及操作安全。

### 注

由于HiKOKI的持续研究和开发计划，此处的规格如有更改，恕不另行通知。

## CORDLESS TRIPOD LIGHT SAFETY WARNINGS

### WARNING

Read all safety warnings and all instructions.

Failure to follow the warnings and instructions may result in electric shock, fire and/or serious injury.

Save all warnings and instructions for future reference.

1. Use only as described in this manual. Use only manufacturer's recommended attachments.
2. Do not use a tripod light in explosive atmospheres, such as in the presence of flammable liquids, gases or dust.
3. Do not use the tripod light in wet or damp places or in the rain.
  - Doing so may result in electric shock, emission of smoke or malfunction.
4. Do not disassemble or modify the tripod light.
  - Doing so may result in electric shock or fire. Inspections and repairs should be performed by the store where purchased or by a HiKOKI power tool service center.
5. Do not let any unspecified objects or water get inside the tripod light body.
  - If any metal or flammable object or water gets inside the battery cover and the USB port rubber cover, it may lead to electric shock or fire.
6. Be careful of electrical shock.
7. When not using the tripod light, or when preparing, storing, or transporting it, be sure to turn off the switch on the unit, and detach the battery.
8. Do not cover the tripod light with cloth, cardboard or other materials when the light is on.
9. When the light is turned on, do not look directly into it, point it at people or animals, or aim it toward the eyes.
10. The lens will remain at a high temperature when lit and immediately after use, so do not touch it.
11. Do not use, leave, or store the tripod light in the rain or in humid places.
12. Do not leave the tripod light in a car or the like that tends to be exposed to be searching heat of the sun (above 50°C). Otherwise, troubles can result.
13. Do not leave the tripod light unattended while it is turned on.
14. Do not use the tripod in strong winds.
15. When working in a high location, ensure that there are no people below, Take the necessary precautions depending on the usage environment to prevent the tripod from toppling or falling.
16. Do not use the tripod light if the lens is damaged or detached.
17. Have your tripod light serviced by a qualified repair person using only identical replacement parts.
  - This will include that the safety of the tripod light is maintained.
18. Use the tripod light only with specifically designated rechargeable battery.
  - Use of any other rechargeable battery may create a risk of injury and fire.
19. Recharge only with the charger specified by the manufacturer.
  - A charger that is suitable for one type of rechargeable battery may create a risk of fire when used with another battery.

20. When rechargeable battery is not in use, keep it away from other metal objects like paper clips, coins, keys, nails, screws, or other small metal objects that can make a connection from one terminal to another.
  - Shorting the battery terminals together may cause burns or a fire.
21. Under abusive conditions, liquid may be ejected from the battery; avoid contact. If contact accidentally occurs, flush with water. If liquid contacts eyes, additionally seek medical help.
  - Liquid ejected from the battery may cause irritation or burns.
22. The battery shall not be exposed to excessive heat such as sunshine, fire or the like.

## ADDITIONAL SAFETY WARNINGS

1. Always charge the battery at a temperature of 0°C–40°C. A temperature of less than 0°C will result in over charging which is dangerous. The battery cannot be charged at a temperature higher than 40°C. The most suitable temperature for charging is that of 20°C–25°C.
2. Do not use the charger continuously. When one charging is completed, leave the charger for about 15 minutes before the next charging of battery.
3. Do not allow foreign matter to enter the hole for connecting the rechargeable battery.
4. Never disassemble the rechargeable battery and charger.
5. Never short-circuit the rechargeable battery. Shortcircuiting the battery will cause a great electric current and overheat. It results in burn or damage to the battery.
6. Do not dispose of the battery in fire. If the battery is burnt, it may explode.
7. Bring the battery to the shop from which it was purchased as soon as the post-charging battery life becomes too short for practical use. Do not dispose of the exhausted battery.
8. Do not insert object into the air ventilation slots of the charger. Inserting metal objects or inflammables into the charger air ventilation slots will result in electrical shock hazard or damaged charger.
9. Make sure that the battery is installed firmly. If it is at all loose it could come off and cause an accident.
10. Do not use the product if the tool or the battery terminals (battery mount) are deformed. Installing the battery could cause a short circuit that could result in smoke emission or ignition.
11. Keep the tool's terminals (battery mount) free of dust.
  - Prior to use, make sure that dust have not collected in the area of the terminals.
  - During use, try to avoid dust on the tool from falling on the battery.
  - When suspending operation or after use, do not leave the tool in an area where it may be exposed to falling dust.
12. Always use the tool and battery at temperatures between -5°C and 40°C.

# English

## CAUTION ON LITHIUM-ION BATTERY

To extend the lifetime, the lithium-ion battery equips with the protection function to stop the output.

In the cases of 1 to 3 described below, when using this product, even if the switch is turned ON, the tripod light may not turn on. This is not the trouble but the result of protection function.

1. When the remaining battery power runs out, the tripod light turns off.  
In such a case, charge it up immediately.
2. If the tool is overloaded, the tripod light may turn off. In this case, release the switch of tool and eliminate causes of overloading. After that, you can use it again.
3. If the battery is overheated under overload work, the battery power may stop.  
In this case, stop using the battery and let the battery cool. After that, you can use it again.

Furthermore, please heed the following warning and caution.

### WARNING

In order to prevent any battery leakage, heat generation, smoke emission, explosion and ignition beforehand, please be sure to heed the following precautions.

1. Make sure that swarf and dust do not collect on the battery.
  - During work make sure that swarf and dust do not fall on the battery.
  - Make sure that any swarf and dust falling on the tool during work do not collect on the battery.
  - Do not store an unused battery in a location exposed to swarf and dust.
  - Before storing a battery, remove any swarf and dust that may adhere to it and do not store it together with metal parts (screws, nails, etc.).
2. Do not pierce battery with a sharp object such as a nail, strike with a hammer, step on, throw or subject the battery to severe physical shock.
3. Do not use an apparently damaged or deformed battery.
4. Do not use the battery for a purpose other than those specified.
5. If the battery charging fails to complete even when a specified recharging time has elapsed, immediately stop further recharging.
6. Do not put or subject the battery to high temperatures or high pressure such as into a microwave oven, dryer, or high pressure container.
7. Keep away from fire immediately when leakage or foul odor are detected.
8. Do not use in a location where strong static electricity generates.
9. If there is battery leakage, foul odor, heat generated, discolored or deformed, or in any way appears abnormal during use, recharging or storage, immediately remove it from the equipment or battery charger, and stop use.
10. Do not immerse the battery or allow any fluids to flow inside. Conductive liquid ingress, such as water, can cause damage resulting in fire or explosion. Store your battery in a cool, dry place, away from combustible and flammable items. Corrosive gas atmospheres must be avoided.

### CAUTION

1. If liquid leaking from the battery gets into your eyes, do not rub your eyes and wash them well with fresh clean water such as tap water and contact a doctor immediately.  
If left untreated, the liquid may cause eye-problems.
2. If liquid leaks onto your skin or clothes, wash well with clean water such as tap water immediately.  
There is a possibility that this can cause skin irritation.

3. If you find rust, foul odor, overheating, discolor, deformation, and/or other irregularities when using the battery for the first time, do not use and return it to your supplier or vendor.

### WARNING

If a conductive foreign matter enters in the terminal of lithium ion battery, the battery may be shorted, causing fire. When storing the lithium ion battery, obey surely the rules of following contents.

- Do not place conductive debris, nail and wires such as iron wire and copper wire in the storage case.
- To prevent shorting from occurring, load the battery in the tool or insert securely the battery cover for storing until the ventilator is not seen.

## REGARDING LITHIUM-ION BATTERY TRANSPORTATION

When transporting a lithium-ion battery, please observe the following precautions.

### WARNING

Notify the transporting company that a package contains a lithium-ion battery, inform the company of its power output and follow the instructions of the transportation company when arranging transport.

- Lithium-ion batteries that exceed a power output of 100 Wh are considered to be in the freight classification of Dangerous Goods and will require special application procedures.
- For transportation abroad, you must comply with international law and the rules and regulations of the destination country.

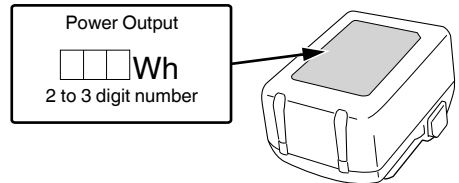

## PRECAUTIONS REGARDING THE DUST-RESISTANCE AND WATER-PROOFING FUNCTIONS

This product conforms to IP55 protection class ratings (dust-resistance and water-proofing) for electrical equipment as stipulated by the international IEC regulations. (When the battery cover is closed, the tool's body alone meets the equivalent of the IP55 protection standard.)

### [Descriptions of IP Codes]









#### IP55



- Protection rating for water penetration  
Water sprayed from any direction shall have no harmful effect (water spray proof)
- Protection rating for external assault by solid objects  
The presence of a small amount of dust will not affect normal operations (dust-resistant).

The equipment has been designed to withstand the effects of dust and water, but there is no guarantee that it will not malfunction. Do not use or leave the equipment in locations where it is subject to excessive amounts of dust, or in locations where it is submerged in water or subject to rainwater.

## NAMES OF PARTS (Fig. 1–Fig. 11)

①	Lens	⑫	Carrying handle
②	Front covers	⑬	Battery cover
③	LED unit	⑭	Battery (sold separately)
④	Extension pole	⑮	Clamp lever
⑤	Storage cover	⑯	Latch
⑥	Locking lever (A)	⑰	Pilot lamp
⑦	Locking lever (B)	⑱	Screws (x2 each top and bottom) (individual light angle adjustment)
⑧	Switch	⑲	Screws (x2) (vertical angle adjustment)
⑨	Top handle	⑳	Hex socket head screw (horizontal angle adjustment)
⑩	Leg	㉑	Locking lever upper screws
⑪	Leg opening lever	㉒	Locking lever lower screws (Adjust when tightening the upper screws is insufficient)



	Alternating current
	Do not look directly at the LED light while it is lit.
	Disconnect the battery
	Switching ON
	Switching OFF
	Lock
	Unlock
	Warning
V	volts
A	amperes
W	watts
IPXX	IP symbol

	Be sure to open the legs before extending the pole.
	Be careful not to pinch your hands or fingers in the sliding parts during operation.

## SYMBOLS

### WARNING

The following show symbols used for the machine. Be sure that you understand their meaning before use.

	UB18DG : Cordless Tripod Light
	To reduce the risk of injury, user must read instruction manual.
	Direct current

## APPLICATIONS

Illumination of work site

## SPECIFICATIONS

Model		UB18DG	
Voltage		18 V	
LED (white)		×66	
Brightness adjustment range		1000 lm, 2000 lm, 3000 lm, 4000 lm	
Operating time, approx. (Using full charged battery)*	Max (4000 lm)	3.0 Ah: 1.5 hours 5.0 Ah: 2.5 hours 8.0 Ah: 4.0 hours	
	High (3000 lm)	3.0 Ah: 2.1 hours 5.0 Ah: 3.5 hours 8.0 Ah: 5.6 hours	
	Mid (2000 lm)	3.0 Ah: 3.3 hours 5.0 Ah: 5.5 hours 8.0 Ah: 8.8 hours	
	Low (1000 lm)	3.0 Ah: 6.3 hours 5.0 Ah: 10.5 hours 8.0 Ah: 16.8 hours	
Exterior dimensions	Extended	H 2150 mm × L 630 mm × W 720 mm	
	Retracted	H 1035 mm × L 222 mm × W 210 mm	
Weight		8.1 kg (without battery)	

\* The operating times shown are reference values only. The actual time varies depending on the charging state of the battery, the usage conditions, etc. For the BSL36A18, refer to the 5.0 Ah figures; for the BSL36B18, refer to the 8.0 Ah figures.

### NOTE

Due to HIKOKI's continuing program of research and development, the specifications herein are subject to change without prior notice.

## CHARGING





Before using the tool, charge the battery as follows.

- 1. Connect the charger's power cord to the receptacle.**  
When connecting the plug of the charger to a receptacle, the pilot lamp will blink in red (At 1-second intervals).
- 2. Insert the battery into the charger.**  
Firmly insert the battery into the charger as shown in Fig. 3.
- 3. Charging**  
When inserting a battery in the charger, charging will commence and the pilot lamp will light continuously in red.  
When the battery becomes fully recharged, the pilot lamp will blink in red. (At 1-second intervals) (See Table 1)

### ● Pilot lamp indication

The indications of the pilot lamp will be as shown in Table 1, according to the condition of the charger or the rechargeable battery.

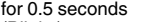
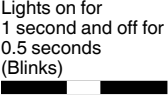
Table 1

Indications of the pilot lamp (RED)		
Before charging	Lights on for 0.5 seconds and off for 0.5 seconds (Blinks) 	Plugged into power source
While charging	Lights continuously (Lights) 	—
Charging complete	Lights on for 0.5 seconds and off for 0.5 seconds (Blinks) 	—
Overheat standby	Lights on for 1 second and off for 0.5 seconds (Blinks) 	Battery overheated. Unable to charge. (Charging will commence when battery cools)
Charging impossible	Lights on for 0.1 seconds and off for 0.1 seconds (Flickers) 	Malfunction in the battery or the charger

- Regarding the temperatures and charging time of the battery.  
The temperatures and charging time will become as shown in Table 2.

Table 2

Charger		UC18YFSL
Battery		
Charging voltage	V	14.4–18
Weight	kg	0.5
Temperatures at which the battery can be recharged		0°C–50°C
Charging time for battery capacity, approx. (At 20°C)		
1.5 Ah	min	22
2.0 Ah	min	30
2.5 Ah	min	35
3.0 Ah	min	45
4.0 Ah	min	60
5.0 Ah	min	75
6.0 Ah	min	90
8.0 Ah	min	120
Number of battery cells		4–10

### NOTE

The recharging time may vary according to temperature and power source voltage.

### CAUTION

When the battery charger has been continuously used, the battery charger will be heated, thus constituting the cause of the failures. Once the charging has been completed, give 15 minutes rest until the next charging.

- 4. Disconnect the charger's power cord from the receptacle.**

## 5. Hold the charger firmly and pull out the battery.

### NOTE

Be sure to pull out the battery from the charger after use, and then keep it.

### Regarding electric discharge in case of new batteries, etc.

As the internal chemical substance of new batteries and batteries that have not been used for an extended period is not activated, the electric discharge might be low when using them the first and second time. This is a temporary phenomenon, and normal time required for recharging will be restored by recharging the batteries 2–3 times.

### How to make the batteries perform longer.

- (1) Recharge the batteries before they become completely exhausted.

When you feel that the power of the tool becomes weaker, stop using the tool and recharge its battery. If you continue to use the tool and exhaust the electric current, the battery may be damaged and its life will become shorter.

- (2) Avoid recharging at high temperatures.

A rechargeable battery will be hot immediately after use. If such a battery is recharged immediately after use, its internal chemical substance will deteriorate, and the battery life will be shortened. Leave the battery and recharge it after it has cooled for a while.

### CAUTION

- If the battery is charged while it is heated because it has been left for a long time in a location subject to direct sunlight or because the battery has just been used, the pilot lamp of the charger lights for 1 second, does not light for 0.5 seconds (off for 0.5 seconds). In such a case, first let the battery cool, then start charging.
- When the pilot lamp flickers (at 0.2-second intervals), check for and take out any foreign objects in the charger's battery connector. If there are no foreign objects, it is probable that the battery or charger is malfunctioning. Take it to your authorized Service Center.

## MOUNTING AND OPERATION

Action	Figure	Page
Removing and inserting the battery	2	2
Charging	3	2
Installing the tripod light*1	4	3
Opening and closing the legs*2	5	3
Adjusting the LED unit angle*3	6	3
Adjusting the LED unit height*4	7	3
Turning the light on*5	8	4
Precautions when retracting the tripod*6	9	4
Transporting the tripod*7	10	4
Adjusting the tripod light *8	11	4
Selecting accessories	—	17

- \*1 Installing the tripod light

### WARNING

- Do not use in locations where the tripod may fall over.
- Be sure to open the legs before extending the pole.

- \*2 Opening and closing the legs

### WARNING

- Use the product with the legs spread completely and locked in position.
- Be careful not to pinch your hands or fingers in the sliding parts during operation.

- \*3 Adjusting the LED unit angle

- (1) Release the locking lever (A), raise the LED unit approximately 30 cm, then lock the locking lever (A) in place again. (Fig. 6-a) Now adjust the lens angle. (Fig. 6-b)

- (2) After adjusting the angle, release the locking lever (A), and raise the LED unit to the desired height. Once in the desired position, lock the locking lever (A) in place again. If the unit is too low, release the locking lever (B), and extend as necessary.

- \*4 Adjusting the LED unit height

### WARNING

- Be careful not to pinch your hands or fingers in the sliding parts during operation.
- Be sure to keep the locking levers locked except when adjusting the height.
- To prevent injury, retract the pole when not in use.

### NOTE

- Turn off the light before adjusting the LED unit angle.

- \*5 Turning the light on

When the battery level falls to 5% or lower, the light will flicker briefly every three minutes to alert the user. If this occurs, replace the battery.

- \*6 Precautions when retracting the tripod

### WARNING

Be careful not to pinch your hands or fingers in the sliding parts during operation.

- \*7 Transporting the tripod

### WARNING

When moving or transporting the tripod light:

- Turn off the switch, and detach the rechargeable battery from the tripod light.
- Place the LED unit back inside its storage cover.
- Secure the locking levers (A) and (B).
- Fold up the tripod.
- Close the battery cover.

# English

## NOTE

- Hold the tripod so that the LED unit is pointing forward.
  - Hold the tripod at the rear of its carrying handle, taking care not to press the leg opening lever.  
Note that an accident may occur if the lock is released and the tripod is allowed to move.
- \*8 If the sliding parts become loose with use, adjust by retightening the screws.  
If the upper screw alone is not sufficient to retighten, adjust the lower screw. (**Fig. 11-b**)

---

## NOTE

Due to HiKOKI's continuing program of research and development, the specifications herein are subject to change without prior notice.

---

## MAINTENANCE AND INSPECTION

### WARNING

When not using the tripod light for a long time, or when performing maintenance on it, inspecting it, or storing it, be sure to turn OFF the switch and detach the battery.

#### 1. Inspecting the mounting screws

Regularly inspect all mounting screws and ensure that they are properly tightened. Should any of the screws be loose, retighten them immediately. Failure to do so could result in serious hazard.

#### 2. Inspection of terminals (tool and battery)

Check to make sure that swarf and dust have not collected on the terminals.

On occasion check prior, during and after operation.

### CAUTION

Remove any swarf or dust which may have collected on the terminals.

Failure to do so may result in malfunction.

#### 3. Cleaning on the outside

When the cordless tripod light is stained, wipe with a soft dry cloth or a cloth moistened with soapy water.

Do not use chloric solvents, gasoline or paint thinner, for they melt plastics.

#### 4. Storage

Store the cordless tripod light and the battery in a place in which the temperature is less than 40°C and out of reach of children.

### NOTE

Storing lithium-ion batteries.

Make sure the lithium-ion batteries have been fully charged before storing them.

Prolonged storage (3 months or more) of batteries with a low charge may result in performance deterioration, significantly reducing battery usage time or rendering the batteries incapable of holding a charge.

However, significantly reduced battery usage time may be recovered by repeatedly charging and using the batteries two to five times.

If the battery usage time is extremely short despite repeated charging and use, consider the batteries dead and purchase new batteries.

#### **Important notice on the batteries for the HiKOKI cordless tools**

Please always use one of our designated genuine batteries. We cannot guarantee the safety and performance of our cordless tool when used with batteries other than these designated by us, or when the battery is disassembled and modified (such as disassembly and replacement of cells or other internal parts).



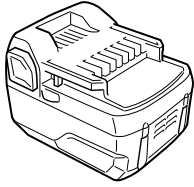

BSL18..

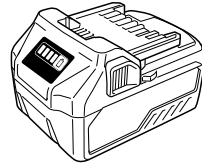

BSL36..18

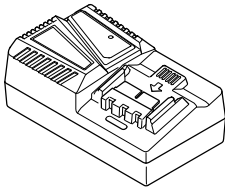

UC18YFSL (14,4 V-18 V)

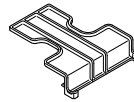

329897

## 产品中有害物质的名称及含量

部件名称	有害物质					
	铅 (Pb)	汞 (Hg)	镉 (Cd)	六价铬 (Cr(VI))	多溴联苯 (PBB)	多溴二苯醚 (PBDE)
外壳部件	○	○	○	○	○	○
电机部件	×	○	○	○	○	○
开关	○	○	○	○	○	○
电镀部件（钢叶片等）	○	○	○	○	○	○
传动部件（齿轮轴等）	○	○	○	○	○	○
电源部件 (电线、引线等)	○	○	○	○	○	○
各种螺丝	○	○	○	○	○	○
铜焊部件 (超硬锯片等)	○	○	○	○	○	○
其它机械部件 (金属件等)	○	○	○	○	○	○
润滑剂（润滑脂等）	○	○	○	○	○	○
充电器	×	○	○	○	○	○
电池	×	○	×	○	○	○

本表格依据 SJ/T 11364 的规定编制。

○：表示该有害物质在该部件所有均质材料中的含量均在 GB/T26572 规定的限量要求以下。

×：表示该有害物质至少在该部件的某一均质材料中的含量超出 GB/T26572 规定的限量要求。

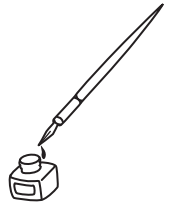

服务中心  
高壹工机商业(上海)有限公司  
上海市闵行区浦江工业园区三鲁路3585号7幢3楼

制造商  
广东高壹工机有限公司  
广东省广州市番禺区化龙镇工业路富裕围工业村

**Koki Holdings Co., Ltd.**

Shinagawa Intercity Tower A, 15-1, Konan 2-chome,  
Minato-ku, Tokyo, Japan

209

编号: C99748121 G  
发行日期: 2022年9月  
中国印刷