

HIKOKI

UR 18DA

 Bluetooth®

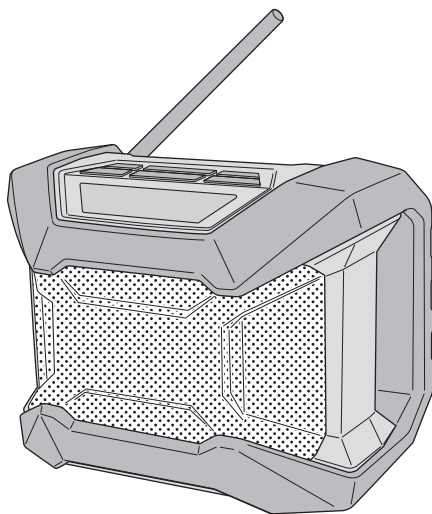

Handling instructions

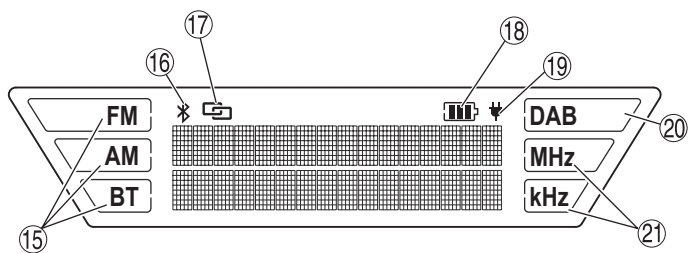
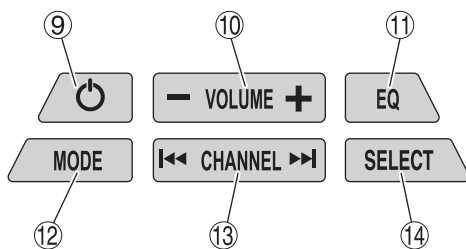
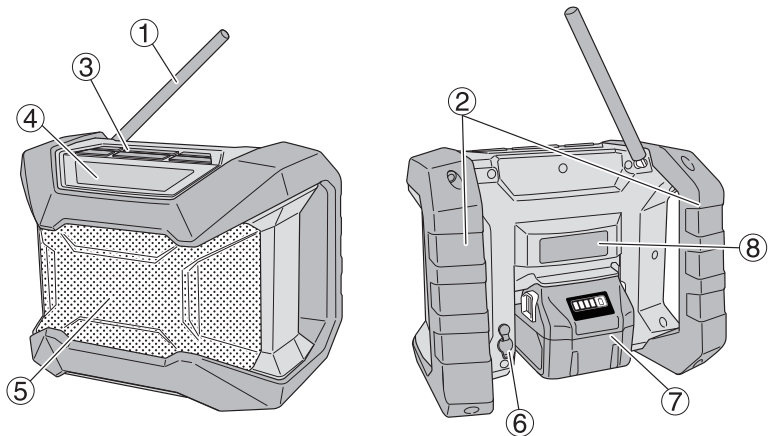

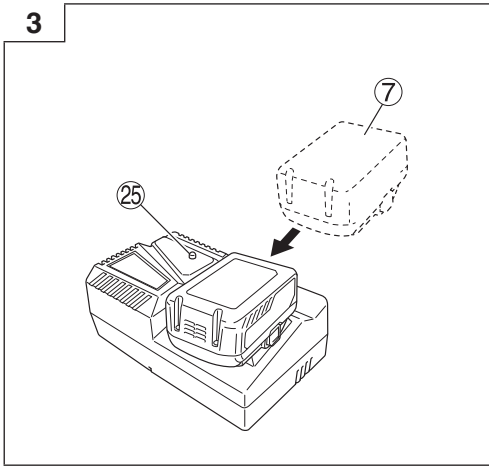
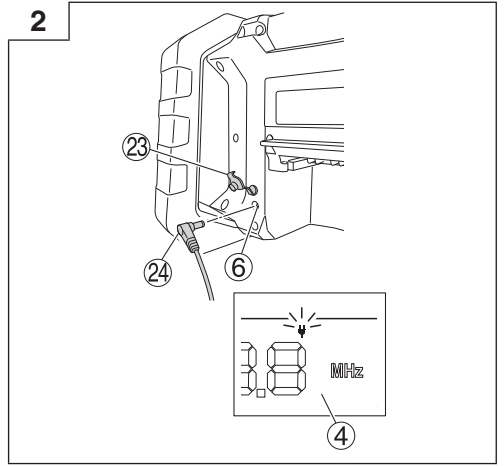
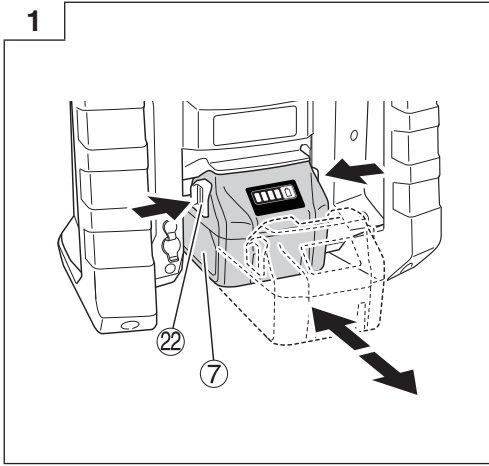

NAMES OF PARTS

①	Antenna	⑩	Volume button	⑲	AC power lamp
②	Handle	⑪	Equalizer button	⑳	DAB broadcast lamp
③	Operation panel	⑫	Mode button	㉑	Unit lamp
④	Display	⑬	Channel selection button	㉒	Latch
⑤	Speaker	⑭	Menu key to select diverse functions	㉓	Rubber cover
⑥	AC adapter port	⑮	Reception mode lamp	㉔	AC adapter
⑦	Battery (Sold separately)	⑯	Bluetooth lamp	㉕	Pilot lamp
⑧	Name plate	⑰	Pairing confirmation lamp		
⑨	Power button	⑱	Remaining battery indicator lamp		

CORDLESS RADIO SAFETY WARNINGS

⚠ WARNING

Read all safety warnings and all instructions.

Failure to follow the warnings and instructions may result in electric shock, fire and/or serious injury.

Save all warnings and instructions for future reference.

1. Use only the specified power supply voltage.

- Use of any other voltage may lead to fire or electric shock.

2. Avoid damaging the AC adapter cord.

- Do not modify, forcibly bend, twist or pull the cord, place heavy objects on it or place it near heating appliances.
- When not in use, remove the power plug (AC adapter) from the electric socket and from the radio. Failure to do so may lead to electric shock or fire.

3. Do not touch the power plug (AC adapter) with wet hands.

- Doing so may result in electric shock.

4. Do not use the radio in the bathroom or shower.

- Do not use the radio in wet or damp places or in the rain.
- Doing so may result in electric shock, emission of smoke or malfunction.

5. Do not touch the FM antenna or power plug (AC adapter) during thunderstorms.

- Doing so may result in electric shock.

6. Do not disassemble or modify the radio.

- Doing so may result in electric shock or fire. Inspections and repairs should be performed by the store where purchased or by a HiKOKI power tool service center.

7. Insert the power plug (AC adapter) securely as far as it will go.

- Dust or dirt between the power plug and the electric socket may lead to fire. Remove the power plug periodically and wipe off any dust or dirt with a dry cloth.

8. Do not let any unspecified objects or water get inside the radio body.

- With the exception of the AC adapter and the rechargeable battery, if any metal or flammable object or water gets inside the back door, it may lead to electric shock or fire.
- Take care to prevent iron powder from the bass reflex speakers, dust or water getting into the radio.

9. Do not sit or stand on the radio.

- Doing so may lead to accidents or malfunction.

10. Do not place the radio on an unstable surface or in a high place.

11. When no slide battery is loaded, attach the slide terminal cover to the terminal to prevent cuts and other injuries that may result from touching the terminal area.

12. If is displayed when you turn the power on with the rechargeable battery inserted, the battery power is low.

- Power the radio from the AC adapter or insert a charged battery.

13. Recharge only with the charger specified by the manufacturer.

- A charger that is suitable for one type of rechargeable battery may create a risk of fire when used with another battery.

14. Use the radio only with specifically designated rechargeable battery.

- Use of any other rechargeable battery may create a risk of injury and fire.

15. When rechargeable battery is not in use, keep it away from other metal objects like paper clips, coins, keys, nails, screws, or other small metal objects that can make a connection from one terminal to another.

- Shorting the battery terminals together may cause burns or a fire.

16. Under abusive conditions, liquid may be ejected from the battery; avoid contact. If contact accidentally occurs, flush with water. If liquid contacts eyes, additionally seek medical help.

- Liquid ejected from the battery may cause irritation or burns.

17. Have your radio serviced by a qualified repair person using only identical replacement parts.

- This will ensure that the safety of the radio is maintained.

18. The main unit and adapter shall not be exposed to dripping or splashing and that no objects filled with liquids, such as vases, shall be placed on the unit and adapter.

19. The battery shall not be exposed to excessive heat such as sunshine, fire or the like.

20. The MAINS plug of adapter is used as the disconnect device, the disconnect device shall remain readily operable.

21. Risk of explosion if the battery is replaced by an incorrect type

- high or low extreme temperatures that a battery can be subjected to during use, storage or transportation (Such as operation temperature: 35°C); and
- low air pressure at high altitude (Altitude: 2000 meter).
- replacement of a battery with an incorrect type that can defeat a safeguard (for example, in the case of some lithium battery types);
- disposal of a battery into fire or a hot oven, or mechanically crushing or cutting of a battery, that can result in an explosion;
- leaving a battery in an extremely high temperature surrounding environment that can result in an explosion or the leakage of flammable liquid or gas;
- a battery subjected to extremely low air pressure that may result in an explosion or the leakage of flammable liquid or gas.

22. Electrostatic discharge may result in malfunction which may require user reset.

ADDITIONAL SAFETY WARNINGS

1. Always charge the battery at a temperature of 0°C–40°C. A temperature of less than 0°C will result in over charging which is dangerous. The battery cannot be charged at a temperature higher than 40°C. The most suitable temperature for charging is that of 20°C–25°C.
2. Do not use the charger continuously. When one charging is completed, leave the charger for about 15 minutes before the next charging of battery.
3. Do not allow foreign matter to enter the hole for connecting the rechargeable battery.
4. Never disassemble the rechargeable battery and charger.
5. Never short-circuit the rechargeable battery. Shortcircuiting the battery will cause a great electric current and overheat. It results in burn or damage to the battery.
6. Do not dispose of the battery in fire. If the battery is burnt, it may explode.
7. Bring the battery to the shop from which it was purchased as soon as the post-charging battery life becomes too short for practical use. Do not dispose of the exhausted battery.
8. Do not insert object into the air ventilation slots of the charger. Inserting metal objects or inflammables into the charger air ventilation slots will result in electrical shock hazard or damaged charger.
9. When using this unit continuously, the unit may overheat, leading to damage in the motor and switch. Therefore, whenever the housing becomes hot, give the tool a break for a while.
10. Make sure that the battery is installed firmly. If it is at all loose it could come off and cause an accident.
11. Do not use the product if the tool or the battery terminals (battery mount) are deformed. Installing the battery could cause a short circuit that could result in smoke emission or ignition.
12. Keep the tool's terminals (battery mount) free of swarf and dust.
 - Prior to use, make sure that swarf and dust have not collected in the area of the terminals.
 - During use, try to avoid swarf or dust on the tool from falling on the battery.
 - When suspending operation or after use, do not leave the tool in an area where it may be exposed to falling swarf or dust. Doing so could cause a short circuit that could result in smoke emission or ignition.

13. In case of use BSL36B18, never use when the temperature is below 0°C or above 40°C. In case of use AC adapter, never use when the temperature is below 0°C or above 25°C.

CAUTION ON LITHIUM-ION BATTERY

To extend the lifetime, the lithium-ion battery equips with the protection function to stop the output.

In the cases of 1 to 3 described below, when using this product, even if you are pulling the switch, the motor may stop. This is not the trouble but the result of protection function.

1. When the battery power remaining runs out, the motor stops.
 - In such a case, charge it up immediately.
2. If the tool is overloaded, the motor may stop. In this case, release the switch of tool and eliminate causes of overloading. After that, you can use it again.
3. If the battery is overheated under overload work, the battery power may stop.
 - In this case, stop using the battery and let the battery cool. After that, you can use it again.

Furthermore, please heed the following warning and caution.

WARNING

In order to prevent any battery leakage, heat generation, smoke emission, explosion and ignition beforehand, please be sure to heed the following precautions.

1. Make sure that swarf and dust do not collect on the battery.
 - During work make sure that swarf and dust do not fall on the battery.
 - Make sure that any swarf and dust falling on the power tool during work do not collect on the battery.
 - Do not store an unused battery in a location exposed to swarf and dust.
 - Before storing a battery, remove any swarf and dust that may adhere to it and do not store it together with metal parts (screws, nails, etc.).
2. Do not pierce battery with a sharp object such as a nail, strike with a hammer, step on, throw or subject the battery to severe physical shock.
3. Do not use an apparently damaged or deformed battery.
4. Do not use the battery in reverse polarity.
5. Do not connect directly to an electrical outlets or car cigarette lighter sockets.
6. Do not use the battery for a purpose other than those specified.
7. If the battery charging fails to complete even when a specified recharging time has elapsed, immediately stop further recharging.
8. Do not put or subject the battery to high temperatures or high pressure such as into a microwave oven, dryer, or high pressure container.
9. Keep away from fire immediately when leakage or foul odor are detected.
10. Do not use in a location where strong static electricity generates.
11. If there is battery leakage, foul odor, heat generated, discolored or deformed, or in any way appears abnormal during use, recharging or storage, immediately remove it from the equipment or battery charger, and stop use.
12. Do not immerse the battery or allow any fluids to flow inside. Conductive liquid ingress, such as water, can cause damage resulting in fire or explosion. Store your battery in a cool, dry place, away from combustible and flammable items. Corrosive gas atmospheres must be avoided.

CAUTION

1. If liquid leaking from the battery gets into your eyes, do not rub your eyes and wash them well with fresh clean water such as tap water and contact a doctor immediately.

- If left untreated, the liquid may cause eye-problems.
- If liquid leaks onto your skin or clothes, wash well with clean water such as tap water immediately. There is a possibility that this can cause skin irritation.
 - If you find rust, foul odor, overheating, discolor, deformation, and/or other irregularities when using the battery for the first time, do not use and return it to your supplier or vendor.

WARNING

If a conductive foreign matter enters in the terminal of lithium ion battery, the battery may be shorted, causing fire. When storing the lithium ion battery, obey surely the rules of following contents.

- Do not place conductive debris, nail and wires such as iron wire and copper wire in the storage case.
- To prevent shorting from occurring, load the battery in the tool or insert securely the battery cover for storing until the ventilator is not seen.

REGARDING LITHIUM-ION BATTERY TRANSPORTATION

When transporting a lithium-ion battery, please observe the following precautions.

WARNING

Notify the transporting company that a package contains a lithium-ion battery, inform the company of its power output and follow the instructions of the transportation company when arranging transport.

- Lithium-ion batteries that exceed a power output of 100 Wh are considered to be in the freight classification of Dangerous Goods and will require special application procedures.
- For transportation abroad, you must comply with international law and the rules and regulations of the destination country.
- If the BSL36B18 (sold separately) is installed in the power tool, the power output will exceed 100 Wh and the unit will be classified as Dangerous Goods for freight classification.

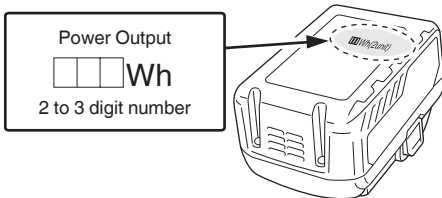

PROTECTING YOUR HEARING

Continuous exposure to loud noise may result in permanent hearing loss. The louder the volume, the shorter the time in which hearing loss may occur.

If you listen to large volume sound over a long period of time, your ears will become accustomed to it. This creates the illusion that the volume level is appropriate, despite the fact that it may be damaging your hearing. Observe the following to prevent hearing loss.

CAUTION

- Make sure you give your ears a rest by taking regular breaks and not listening for long periods of time.**

Even when set at safe volume levels, listening continuously over long periods of time may cause hearing loss.

- Be careful not to increase the volume as your hearing adapts to the sound output.**
Beware of being accustomed to a certain volume level. Adjust the volume to a safe level before your ears become accustomed to loud volumes.
- If your ears begin to ring, if you feel any discomfort, or if conversation seems faint or indistinct, discontinue listening to music and have your ears examined by a doctor.**

PRECAUTIONS WHEN CONNECTING TO EXTERNAL EQUIPMENT

Unexpected problems may result in the loss or corruption of data stored in smartphones and other peripheral equipment connected to the radio. With this possibility in mind, a backup of the data should always be made in advance.

Note that HiKOKI cannot be held responsible for the corruption or loss of data stored within smartphones and other peripheral equipment connected to the radio, nor any damage to the equipment itself.

MAIN FUNCTIONS

- Playback of Bluetooth devices
- Manual/Auto select
- Save (Memory) (10 AM + 10 FM stations)
- Compatibility with HiKOKI power tool rechargeable battery and AC adapter

SPECIFICATIONS

Frequency band	DAB / DAB+: 174.928 to 239.200 MHz (BAND III) FM: 87.5 to 108 MHz AM: 522 to 1710 KHz
Antenna	DAB/DAB+: Rubber antenna FM: Rubber antenna AM: Ferrite bar antenna (built-in)
Speaker	8 W × 1
Max. power output	AC adapter: 7 W 18 V: 7 W
Power supply	Slide battery: DC 18 V Household power supply (using provided AC adapter)
Bluetooth	Bluetooth Ver. 4.2 BR/EDR Profile: A2DP (Advanced Audio Distribution Profile) AVRCP (AV Remote Control Profile) Send/receive Sensitivity: Class 2
Exterior dimensions	240 mm × 176 mm × 185 mm (with antenna refracted)
Weight	1.8 kg

- For applicable power supplies see user instructions:

Applicable power suppliers:
(Manufacture) Hung Kay Industrial Co., Ltd.
(Model) HKP24-1800800dA
(Input voltage) 100–240 V ~ (AC)
(Input AC Frequency) 50/60 Hz
(Output voltage) 18 V
(Output current) 0.8 A
(Output power) 14.4 W
(Average active efficiency) 83.9%
(No-load power consumption) 0.10 W

- Only below slide battery could be used (Model) BSL36B18: 18 V 8000 mAh Lithium battery (Manufacture) Koki Holdings Co., Ltd.
- The plug of external adapter was used as disconnect device, the socket-outlet shall be easily accessible

STANDARD ACCESSORIES







In addition to the main unit (1 unit), the package contains the accessories listed on page 10.

Standard accessories are subject to change without notice.

SYMBOLS

WARNING

The following show symbols used for the machine. Be sure that you understand their meaning before use.

	UR18DA : Cordless radio
	For applicable power supplies see user instructions.
	Only use Koki Holdings Co.,Ltd's slide battery
	Battery pack charge level over 75%
	Battery pack charge level 50 to 75%
	Battery pack charge level 25 to 50%
	Battery pack charge level under 25%

CHARGING

Before using the power tool, charge the battery as follows.

1. **Connect the charger's power cord to the receptacle.**
When connecting the plug of the charger to a receptacle, the pilot lamp will blink in red (At 1- second intervals).

CAUTION

Do not use the electrical cord if damaged. Have it repaired immediately.

2. **Insert the battery into the charger.**
Firmly insert the battery into the charger. (Fig. 3).

3. Charging

When inserting a battery in the charger, charging will commence and the pilot lamp will light continuously in red.

When the battery becomes fully recharged, the pilot lamp will blink in red. (At 1-second intervals) (See Table 1)

- Pilot lamp indication

The indications of the pilot lamp will be as shown in Table 1, according to the condition of the charger or the rechargeable battery.

Table 1

Indications of the pilot lamp				
Pilot lamp (red)	Before charging	Blinks	Lights for 0.5 seconds. Does not light for 0.5 seconds. (off for 0.5 seconds)	/
	While charging	Lights	Lights continuously	
	Charging complete	Blinks	Lights for 0.5 seconds. Does not light for 0.5 seconds. (off for 0.5 seconds)	
	Charging impossible	Flickers	Lights for 0.1 seconds. Does not light for 0.1 seconds. (off for 0.1 seconds)	Malfuction in the battery or the charger
	Overheat standby	Blinks	Lights for 1 second. Does not light for 0.5 seconds. (off for 0.5 seconds)	Battery overheated. Unable to charge. (Charging will commence when battery cools)

- Regarding the temperatures and charging time of the battery.
The temperatures and charging time will become as shown in Table 2.

Table 2

		Charger	UC18YFSL
Battery	Type of battery	Li-ion	
	Temperatures at which the battery can be recharged	0°C-50°C	
	Charging voltage	V	18
	Charging time, approx. (At 20°C)	BSL36B18	
		(10 cells)	
	min	120	

NOTE

The recharging time may vary according to the ambient temperature and power source voltage.

CAUTION

When the battery charger has been continuously used, the battery charger will be heated, thus constituting the cause of the failures. Once the charging has been completed, give 15 minutes rest until the next charging.

4. Disconnect the charger's power cord from the receptacle.

5. Hold the charger firmly and pull out the battery.

NOTE

Be sure to pull out the battery from the charger after use, and then keep it.

Regarding electric discharge in case of new batteries, etc.

As the internal chemical substance of new batteries and batteries that have not been used for an extended period is not activated, the electric discharge might be low when using them the first and second time. This is a temporary phenomenon, and normal time required for recharging will be restored by recharging the batteries 2–3 times.

How to make the batteries perform longer.

(1) Recharge the batteries before they become completely exhausted.

When you feel that the power of the tool becomes weaker, stop using the tool and recharge its battery. If you continue to use the tool and exhaust the electric current, the battery may be damaged and its life will become shorter.

(2) Avoid recharging at high temperatures.

A rechargeable battery will be hot immediately after use. If such a battery is recharged immediately after use, its internal chemical substance will deteriorate, and the battery life will be shortened. Leave the battery and recharge it after it has cooled for a while.

CAUTION

- If the battery is charged while it is heated because it has been left for a long time in a location subject to direct sunlight or because the battery has just been used, the pilot lamp of the charger lights up green or lights for 1 second, does not light for 0.5 seconds (off for 0.5 seconds). In such a case, first let the battery cool, then start charging.
- When the pilot lamp flickers in red (at 0.2-seconds intervals), check for and take out any foreign objects in the charger's battery connector. If there are no foreign objects, it is probable that the battery or charger is malfunctioning. Take it to your authorized Service Center.
- Since the built-in micro computer takes about 3 seconds to confirm that the battery being charged with chargers are taken out, wait for a minimum of 3 seconds before reinserting it to continue charging. If the battery is reinserted within 3 seconds, the battery may not be properly charged.

BATTERY INSTALLATION

CAUTION

Do not touch the terminals.

Doing so may result in cuts to the hand or other injuries.

Only HiKOKI battery model BSL36B18 can be used with this device.

Installing the battery

Align the battery with the groove in tool and slip it into place. Always insert it all the way until it locks in place with a little click. If not, it may accidentally fall out of the tool, causing injury to you or someone around you (Fig. 1).

Removing the battery

Withdraw battery from the tool while pressing the latch (2 pcs) of the battery (Fig. 1).

NOTE

- Do not apply any excessive pressure when inserting the battery. If the battery does not easily slide into place, it is not being inserted properly.
Check to see if the battery is facing the correct direction and that there is nothing obstructing the path of insertion.
- If  is displayed when the device is switched on following battery installation, the battery charge is low. In this situation, either use the AC adapter or install a fully charged battery.

AC ADAPTER INSTALLATION

Power can be supplied by plugging the AC adapter (included) into a standard household outlet.

Pull back the rubber cover and connect the AC adapter to the AC adapter port. (Fig. 2)

Next, plug the AC adapter into an electrical outlet.

NOTE

- When used together with the battery, the AC adapter is the main power source and no battery power is consumed.
- When used together with the AC adapter, the battery will not recharge as this device has no recharge function.

USE

1. Switching On and Off

To switch on: Press button.

To switch off: Press button again.

2. Adjusting the volume

Increase volume: press "+" button.

Decrease volume: press "-" button.

3. Change between FM (ultra shortwave), AM (medium wave), Bluetooth (BT) and DAB / DAB+

The set mode is shown in the display (FM / AM / BT / DAB).

To change between FM (ultra shortwave / UKW), AM (medium wave), BT (Bluetooth) and DAB / DAB+, press the "MODE" button several times.

4. Searching for radio stations

Press "|<<" button or ">>|" button to change the frequency. The current frequency is shown on the display.

To search the next **radio station with high signal strength**, press the "|<<" button or press the ">>|" button and **keep pressed briefly**. The frequency of the radio station found is shown on the display.

5. Store set radio station

- (1) Press the "SELECT" button.
- (2) Press ">>|" button to the point the "Store to Preset" and confirm by pressing on the "SELECT" button.
- (3) Select storage number with "|<<" or ">>|" buttons and confirm by pressing on the "SELECT" button.

6. Listening to stored radio stations

- (1) Press the "SELECT" button.
- (2) Press ">>|" button to the point the "Select Preset" and confirm by pressing on the "SELECT" button.
- (3) Select the desired stored radio station with "|<<" or ">>|" buttons and confirm by pressing on the "SELECT" button.

7. DAB/DAB+ (Digital Audio Broadcasting)

Station scan (starts automatically on initial commissioning):

- (1) Press the "SELECT" button.
- (2) Press ">>|" button to select between the "Auto Scan" and "Manual Tune", and confirm by pressing on the "SELECT" button. (Auto Scan should be preferred)

Set the desired station:

- (1) After the "Auto Scan", all the found stations are stored automatically.
- (2) Brows the received stations with "|<<" or ">>|" buttons.

Selection display settings:

- (1) Press the "SELECT" button.
- (2) Press ">>|" button to the point the subitem the "RDS Display" and confirm by pressing on the "SELECT" button.
- (3) Select desired menu with "|<<" or ">>|" buttons.

8. Bluetooth (depending on configuration)

- (1) To change to BT (Bluetooth), press the "MODE" button several times, until BT shows on the display.
- (2) Activate Bluetooth on your smart phone (or another mobile device such as a tablet).
- (3) If your smart phone has detected the radio, it will be shown with the device name "UR18DA".
- (4) On your smart phone establish the connection to the device "UR18DA".
The successful connection is shown on the display by pressing the symbol.
- (5) Start replay e.g. of a song on your smart phone.

9. Setting treble and bass

To change between treble and bass, press the "EQ" button several times.

The active mode is shown on the display:

"TREBLE" and "BASS".

The set value is shown in the display.

To change the setting, press the "-" button or the "+" button.

10. Battery pack, displaying the battery pack charge level



Over 75%

The battery symbol on the display shows the charge level of the battery pack.



50 to 75%



25 to 50%

Recharge an empty battery pack in a suitable HiKOKI charger.



Under 25%

MAINTENANCE AND INSPECTION

WARNING

When not in use or during inspection and maintenance, be sure to remove the AC plug and rechargeable battery.

● Inspecting the mounting screws

Regularly inspect all mounting screws and ensure that they are properly tightened. Should any of the screws be loose, retighten them immediately. Failure to do so could result in serious hazard.

● Inspection of terminals (tool and battery)

Check to make sure that swarf and dust have not collected on the terminals.

On occasion check prior, during and after operation.

CAUTION

Remove any swarf or dust which may have collected on the terminals.

Failure to do so may result in malfunction.

● Cleaning on the outside

When the radio is stained, wipe with a soft dry cloth or a cloth moistened with soapy water.

Do not use chloric solvents, gasoline or paint thinner, for they melt plastics.

● Storing the Radio

Do not store the radio in the following places.

- Within reach of or easily accessible to children
- In humid or dusty places
- In high temperature such as inside a car or exposed to direct sunlight
- In extremely cold places or directly exposed to cold draughts
- Where the temperature changes drastically
- Where it is exposed to smoke or steam such as near a cooking appliance or humidifier

NOTE

Storing lithium-ion batteries.

Make sure the lithium-ion batteries have been fully charged before storing them.

Prolonged storage (3 months or more) of batteries with a low charge may result in performance deterioration, significantly reducing battery usage time or rendering the batteries incapable of holding a charge.

However, significantly reduced battery usage time may be recovered by repeatedly charging and using the batteries two to five times.

If the battery usage time is extremely short despite repeated charging and use, consider the batteries dead and purchase new batteries.

SELECTING ACCESSORIES

The accessories of this machine are listed on page 11.

For details regarding each bit type, please contact the HiKOKI Authorized Service Center.

Important notice on the batteries for the HiKOKI cordless power tools

Please always use one of our designated genuine batteries. We cannot guarantee the safety and performance of our cordless power tool when used with batteries other than these designated by us, or when the battery is disassembled and modified (such as disassembly and replacement of cells or other internal parts).

NOTE

Due to HiKOKI's continuing program of research and development, the specifications herein are subject to change without prior notice.

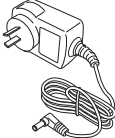
	UR18DA
	(NN)
	1

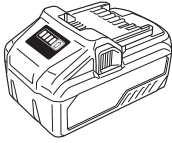

BSL36B18

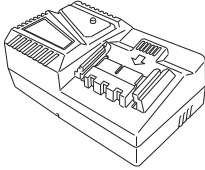

UC18YFSL
(14.4 V-18 V)

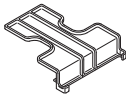

329897

Koki Holdings Co., Ltd.

Shinagawa Intercity Tower A, 15-1, Konan 2-chome,
Minato-ku, Tokyo, Japan